

**2 vie - Sede Sfera in PTFE - O-Ring EPDM - FPM**  
**Attacchi Filettati o Incollaggio - Funzione DE / SE**

**2 way - PTFE - O-Ring EPDM - FPM Ball Seat**  
**Threaded & Plain Female Ends - DA / SR Function**

Valvole per Applicazioni Corrosive  
per Fluidi molto Aggressivi ove i Materiali Metallici non sono compatibili

Valves for Corrosive Applications  
for High Aggressive Fluids where Metallic Material is not suitable



**CARATTERISTICHE TECNICHE - TECHNICAL FEATURES**

**Corpo - Valve Body**

Pressione Nominale Nominal Pressure	PN 16	vds. Diagramma see Diagram
Campo Temperatura Temperature Range	0 ... +60 °C	vds. Diagramma see Diagram
Conessioni Connections	Terminali Filettati - Threaded Ports - ISO 228-1, DIN 2999, ASTM D 2464, JIS B 0203 Femmina Metrici - Plain female ends - EN ISO 1452, EN ISO 15493 BS 4346-1, DIN 8063, NF T54-028, ASTM D 2467, JIS K 6741	

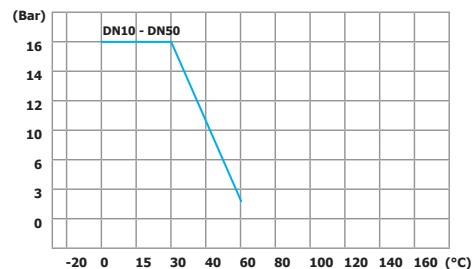

**Attuatore - Actuator**

Campo Temperatura Temperature Range	0 ... +60 °C
Pressione di Comando Control Pressure	da 6.0 bar minimo a 10.0 bar massimo from 6.0 bar minimum to 10.0 bar maximum
Accessori Standard Standard Equipments	Indicatore di Posizione (2) x Viti di Registrazione della Corsa Visual Position Indicator (2) x Travel Adjustment Screws
Accessori Opzionali Optional Equipments	Box Micro con Finecorsa Meccanici o Sensori Proximity Elettrovalvole 5/2 Vie con interfaccia Namur Limit Switch Box with Mechanical or Proximity Switches 5/2 way Solenoid Valves with Namur interface

**Materiali - Materials**

Attuatore - Actuator	Alluminio Anodizzato - Anodized Aluminium
Corpo - Valve Body	01 PVC-U
Sfera - Ball	02 PVC-U
Tenuta Sede - Ball seat	03 PTFE
O-Ring	04 EPDM - FPM

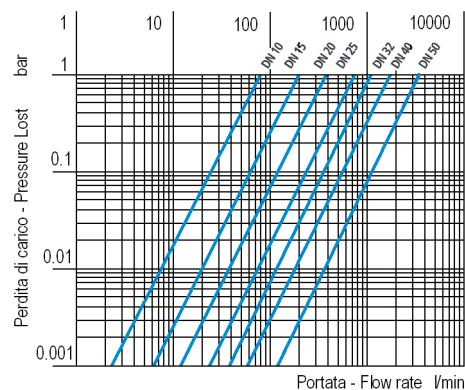
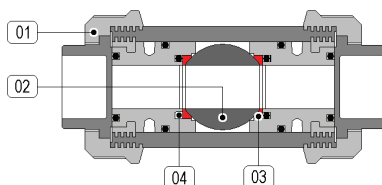

**Fluidi - Fluids**

Valvola idonea per fluidi compatibili con le parti a contatto.  
La scelta dei materiali è responsabilità del cliente che dovrà assicurarsi se adatti all'impiego.  
La scelta è limitata dai dati di temperatura e pressione della valvola  
The valve is suitable for fluids compatible with the parts in contact.  
The user is responsible for the right choice of compatibility with knowledge of the real working conditions.  
The choice of the valve must also consider the conditions of temperature and pressure.

MISURA SIZE	DN	DE / DA	SE / SR - NC	NOTE - REMARKS	SERIE - SERIES	ATTACCHI CORPO BODY CONNECT.	MATERIALE MATERIAL
G 3/8"	Ø 10	522•30U050	522•31U052	sostituire il digit • col materiale desiderato della guarnizione 2 → EPDM	5222	Attacchi Filettati ISO 228 Threaded Ports	PVC-U EPDM
G 1/2"	Ø 15	522•40U050	522•41U052				
G 3/4"	Ø 20	522•50U050	522•51U154	please replace digit • by desired ball O-Ring 2 → EPDM	5224	Attacchi Filettati ISO 228 Threaded Ports	PVC-U FPM
G 1"	Ø 25	522•60U050	522•61U154				
G 1-1/4"	Ø 32	522•70U150	522•71U154				
G 1-1/2"	Ø 40	522•80U150	522•81U204				
G 2"	Ø 50	522•90U150	522•91U204	4 → FKM			

**DIMENSIONI - DIMENSIONS (mm)**

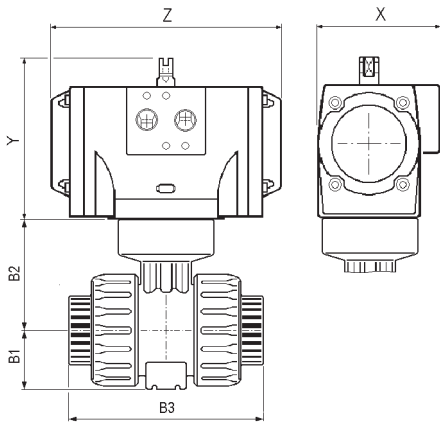

MISURA SIZE DN	FUNZIONE FUNCTION	B1	B2	ATTACCHI - CONNECTIONS											ALU. ACT.		
				"I" D	"L" B3	"A" B3	"J" B3	"D" B3	"F" B3	"N" B3	"G" B3	"O" B3	"S" B3	Y	X	Z	
10	DE/DA	29	58	16	103	103	117	-	149	103	103	-	-	-	101	67	119
	SE/SR	29	58	16											101	67	119
15	DE/DA	29	58	20	103	103	117	131	124	110	111	103	130	130	101	67	119
	SE/SR	29	58	20											101	67	119
20	DE/DA	35	73	25	115	115	129	147	144	116	117	115	150	150	101	67	119
	SE/SR	35	73	25											111	81	175
25	DE/DA	39	74	32	128	128	142	164	154	134	135	128	160	160	101	67	119
	SE/SR	39	74	32											111	81	175
32	DE/DA	46	97	40	146	146	162	182	174	153	153	146	180	180	111	81	175
	SE/SR	46	97	40											111	81	175
40	DE/DA	52	104	50	164	164	172	212	194	156	156	164	200	200	111	81	175
	SE/SR	52	104	50											128	96	186
50	DE/DA	62	114	63	199	199	199	248	224	186	186	199	230	230	111	81	175
	SE/SR	62	114	63											128	96	186

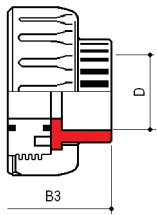

● **Tipo "I" - Type "I"**  
attacchi femmina metrici da incollaggio  
metric series plain female ends

● **Tipo "L" - Type "L"**  
attacchi femmina serie BS da incollaggio  
BS series plain female ends

● **Tipo "A" - Type "A"**  
attacchi femmina serie ASTM  
da incollaggio  
ASTM series plain female ends

● **Tipo "J" - Type "J"**  
attacchi femmina serie JIS  
da incollaggio  
JIS series plain female ends

● **Tipo "D" - Type "D"**  
attacchi maschio metrici  
da incollaggio  
metric series plain male ends

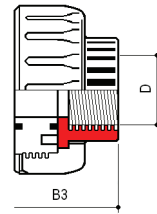

● **Tipo "F" - Type "F"**  
attacchi femmina filetto cilindrico gas  
BS parallel threaded female ends

● **Tipo "N" - Type "N"**  
attacchi femmina filetto cilindrico NPT  
NPT parallel threaded female ends

● **Tipo "G" - Type "G"**  
attacchi femmina filetto JIS  
JIS threaded female ends

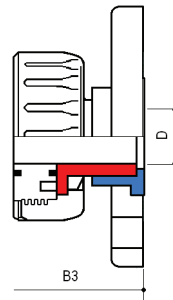

● **Tipo "O" - Type "O"**  
flange libere UNI 2223 PN 10/16, DIN 2501  
scartamento secondo EN 558-1  
UNI 2223 PN 10/16, DIN 2501  
revolving flanges

● **Tipo "S" - Type "S"**  
flange libere foratura ANSI 150 #RF  
ANSI 150 #RF revolving flanges

Connessioni a Flangia EN/ISO/  
DIN foratura PN 10/16

Flanged Connections EN/ISO/  
DIN drilling norm PN 10/16



**ESEMPIO DI MONTAGGIO**

Elettrovalvole per attuatori  
pneumatici con interfaccia Namur

**MOUNTING EXAMPLE**

Control solenoid valve for pneumatic  
actuators with Namur interface

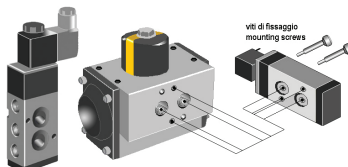

**Tipo A250**

Custodia di Alluminio verniciato  
IP 67 - Atex II 3 GD

**A250 Type**

Epoxy Coated Aluminium Housing  
IP 67 - Atex II 3 GD

